

S = RECOMMENDED
L = SETTING LINE

INTERFACE FAMILY

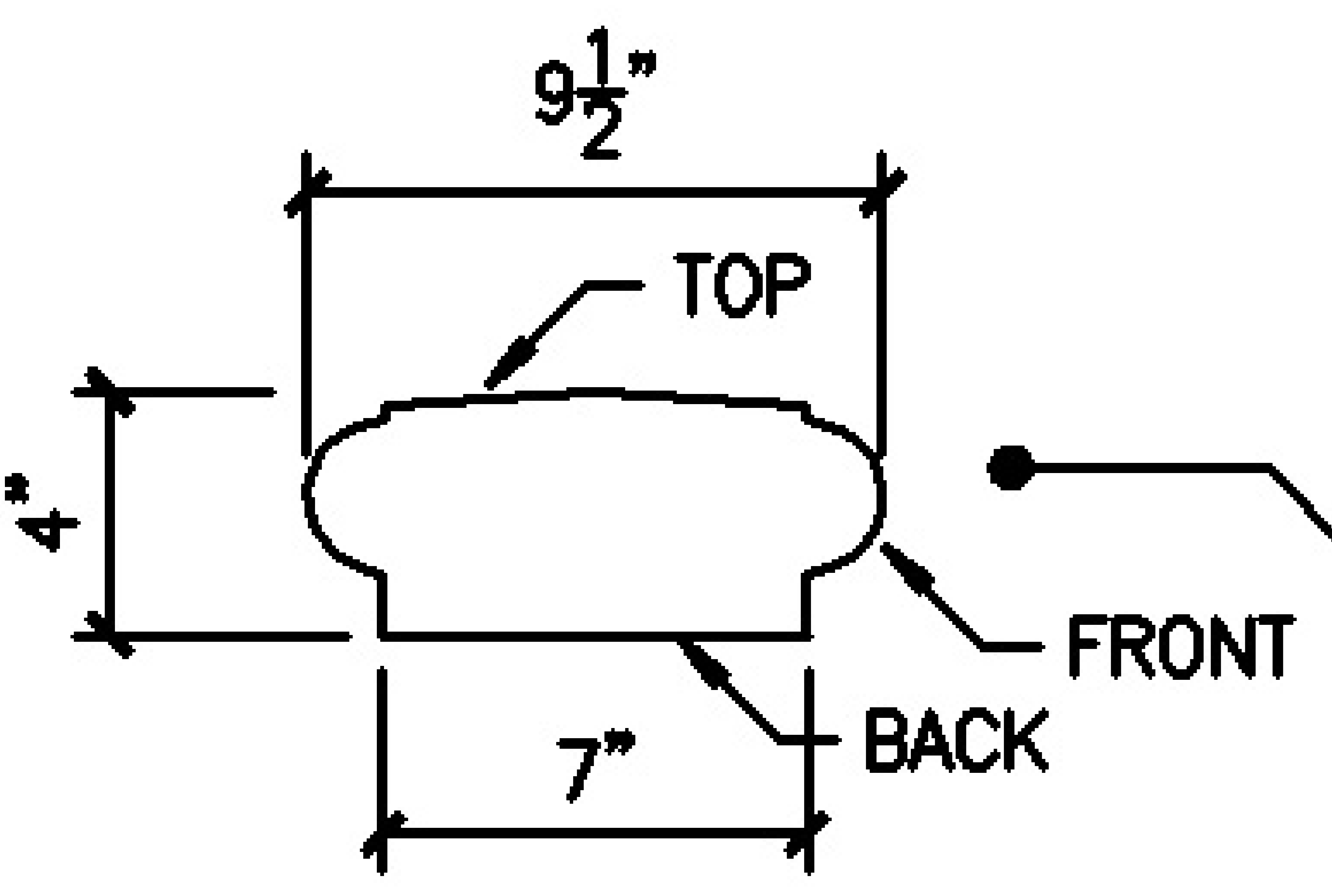

**EXTRADOS1
PROFILE**

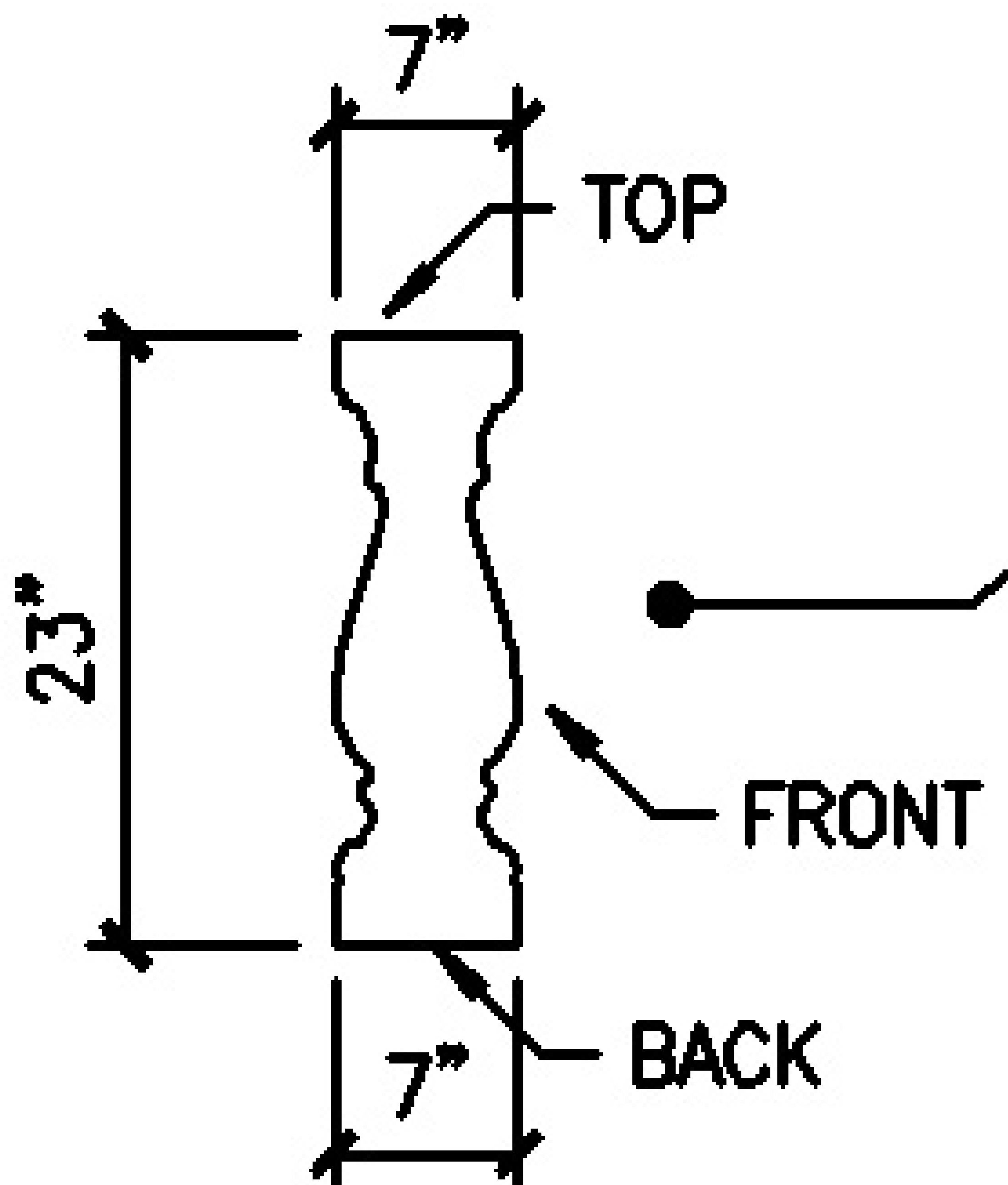

**OTTERWOOD1
PROFILE**

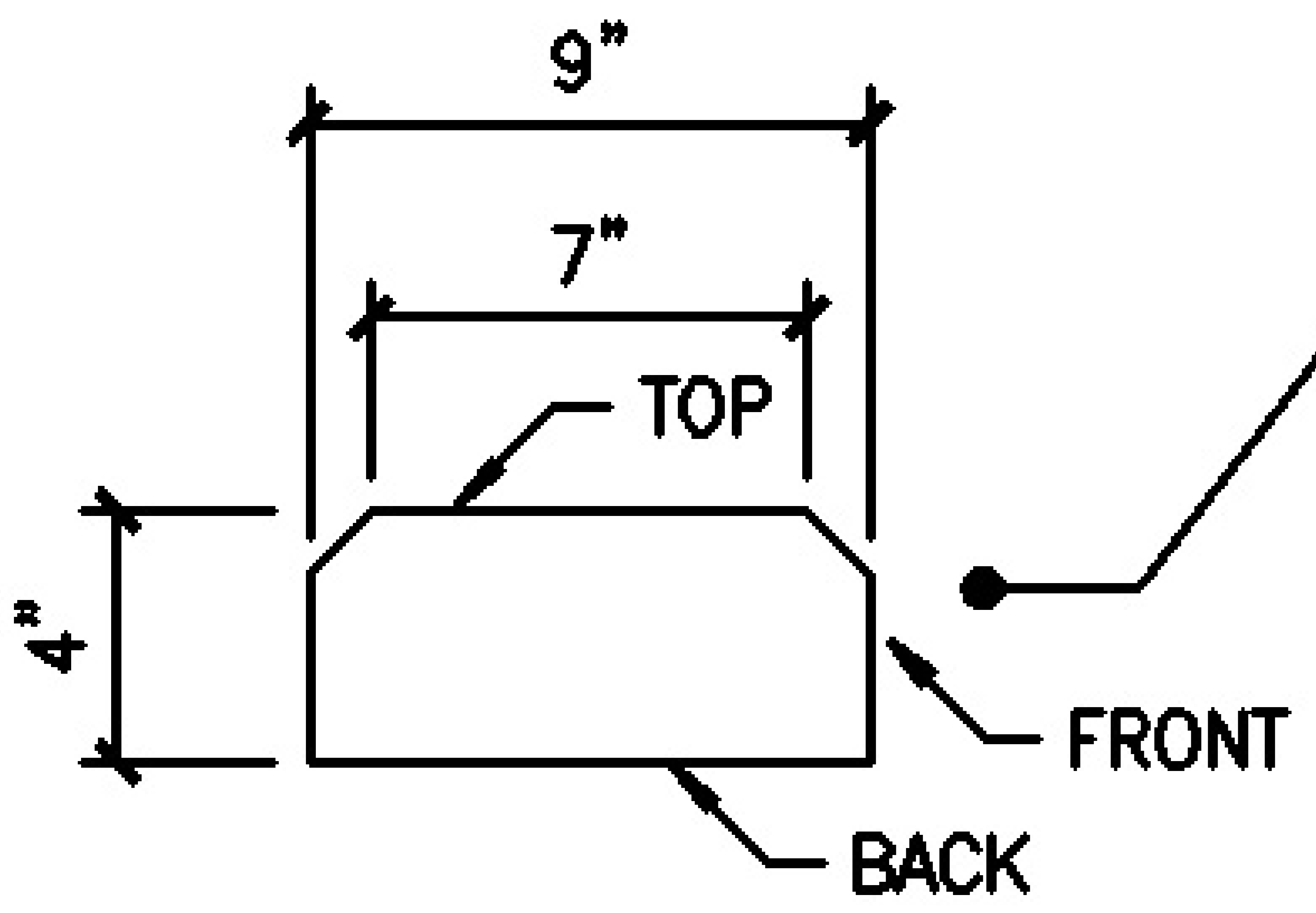

**CHAMFER1
PROFILE**

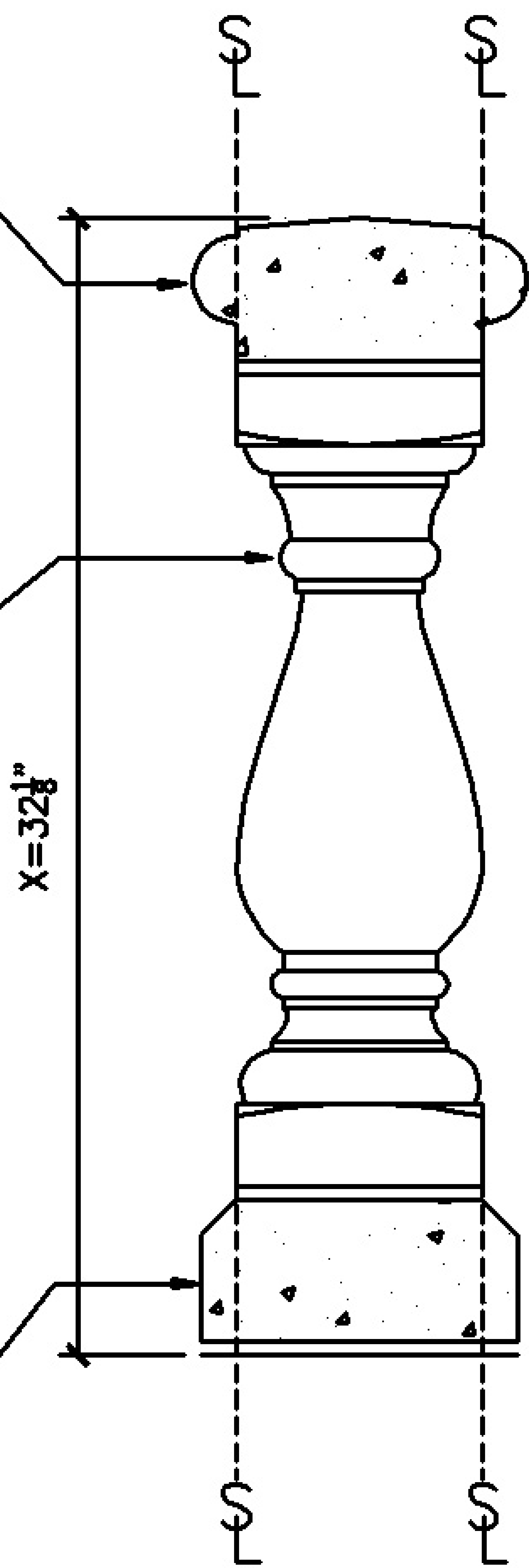

1 VERTICAL SECTION

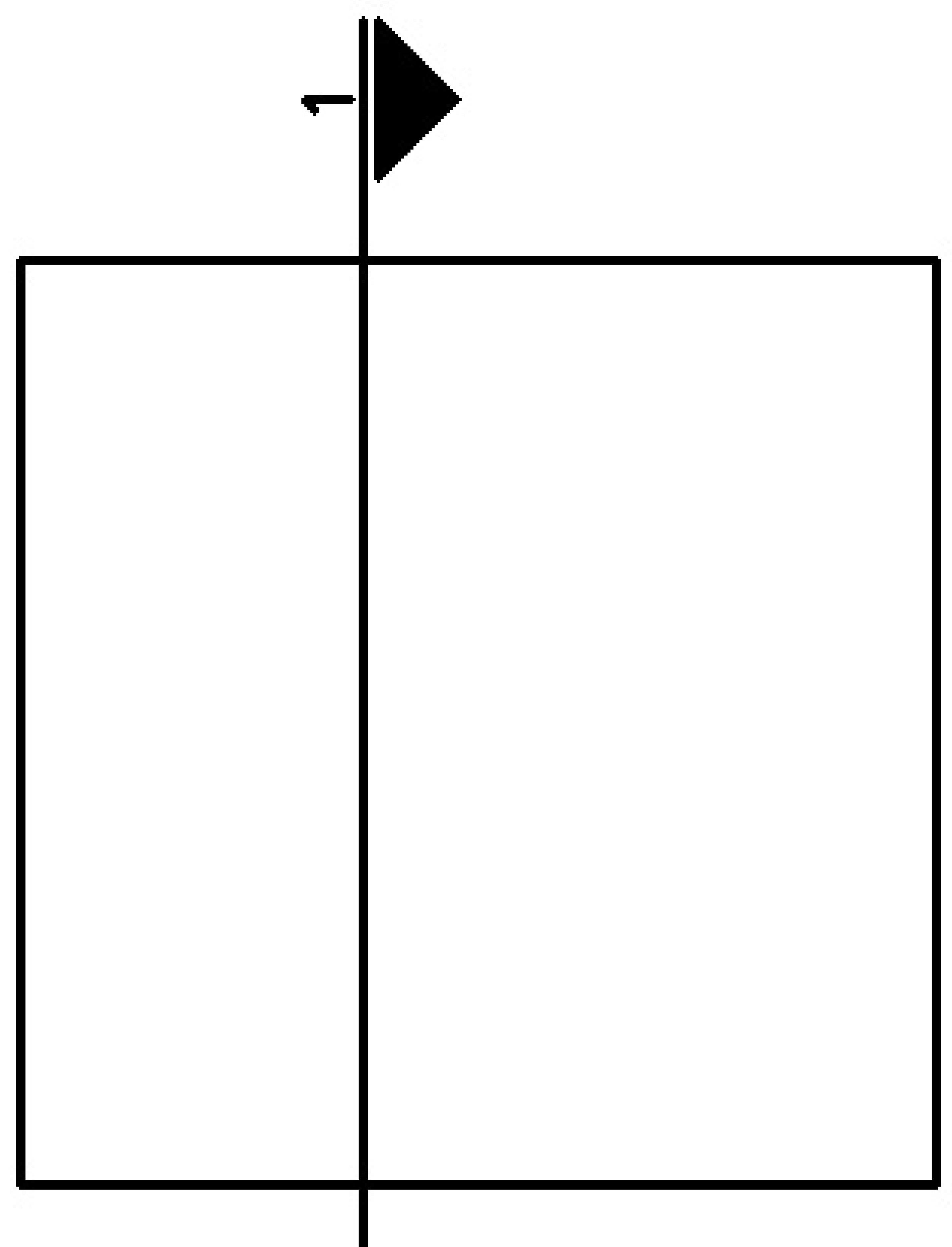

**EXAMPLE PHOTO
OF BALUSTRADE**

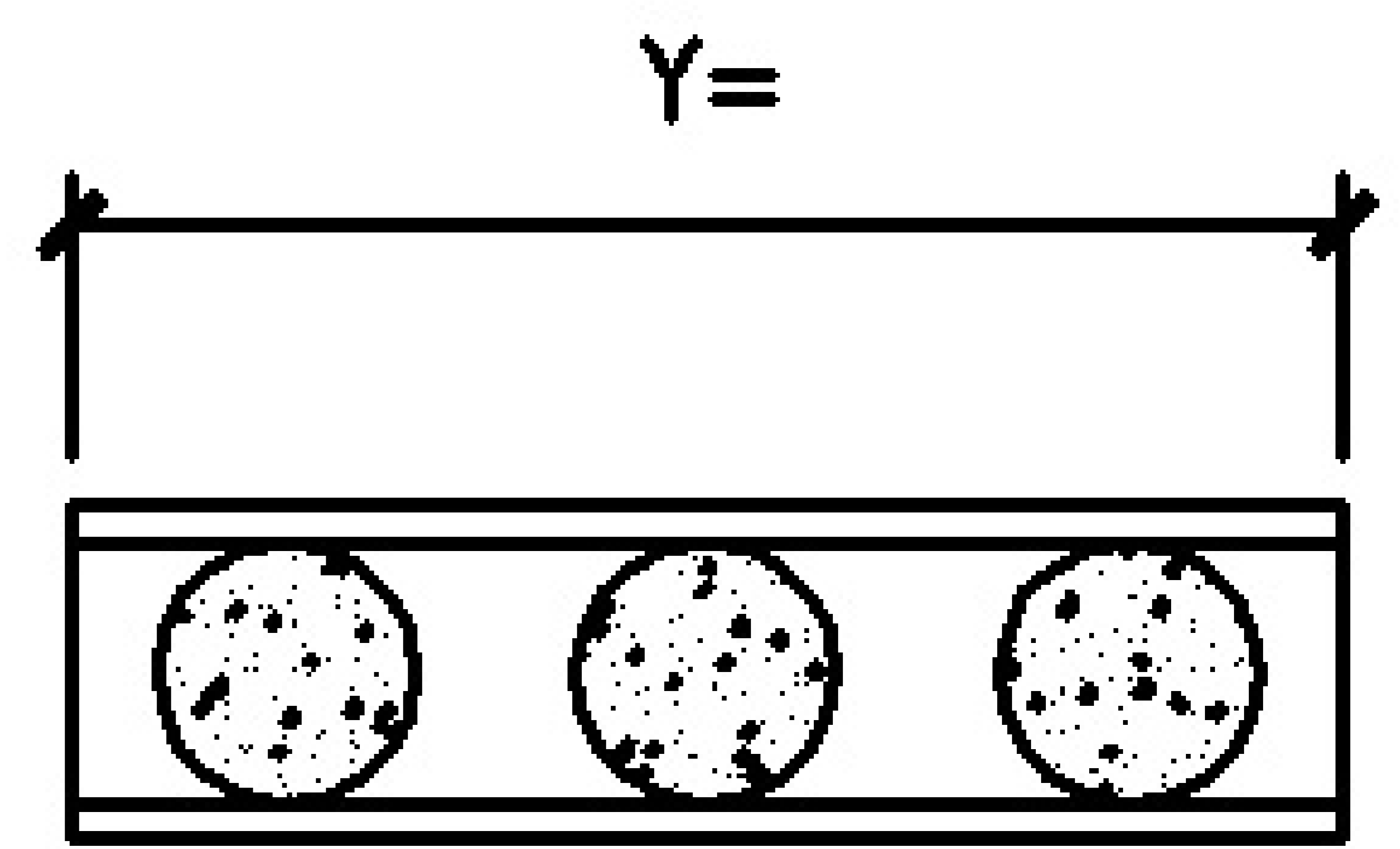

**2 SECTION
EXAMPLE**

BALL CODE TO BE VERIFIED BY
CUSTOMER TO MEET THEIR
LOCAL REQUIREMENTS

HANDRAILS & BASERAIS ARE
SUPPLIED IN TYP. 36" LENGTHS
FOR CUT TO FIT.