

Design Options Keystone

How to Attach a Window Surround

Attachments & Interfaced to Wood/Stucco building dwg. Window Circ Top/Ellipse/Eyebrow & Gothic. Top to Wood/Stucco using Clips, Pins, Screws & Wire

Note: The requirements for attaching stone to structures, varies among the different States. A certified engineer that is familiar with the Geologic Seismic & Climatic conditions of your area must determine the best method for attaching the stone to the structure. The stone supplier is not responsible for providing information on attachment methods and can only provide suggested attachment methods. These suggested methods are well known and have been used throughout the industry. The Stucco/Stone must hide all attachments.

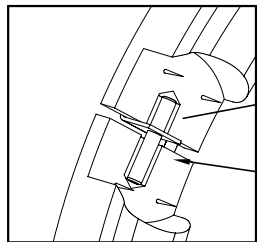

6 Between Stones

Attached to Wood using Pin, L Clip & Screws

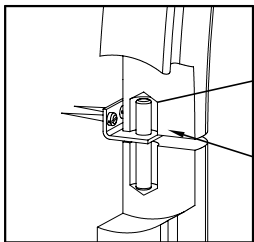

5 Between Stones

Attached to Wood using Pin, L Clip & Screws

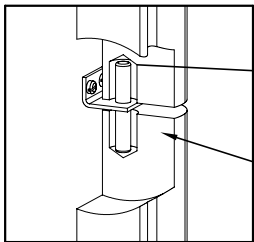

4 Between Stones

Attached to Wood using Pin, L Clip & Screws

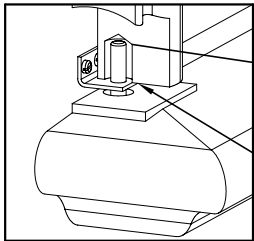

2 Surround & Sill

Attached to Wood using Pin, L Clip & Screws

7 Keystone

to Wood & Stone
Attached with Pin
& Wire

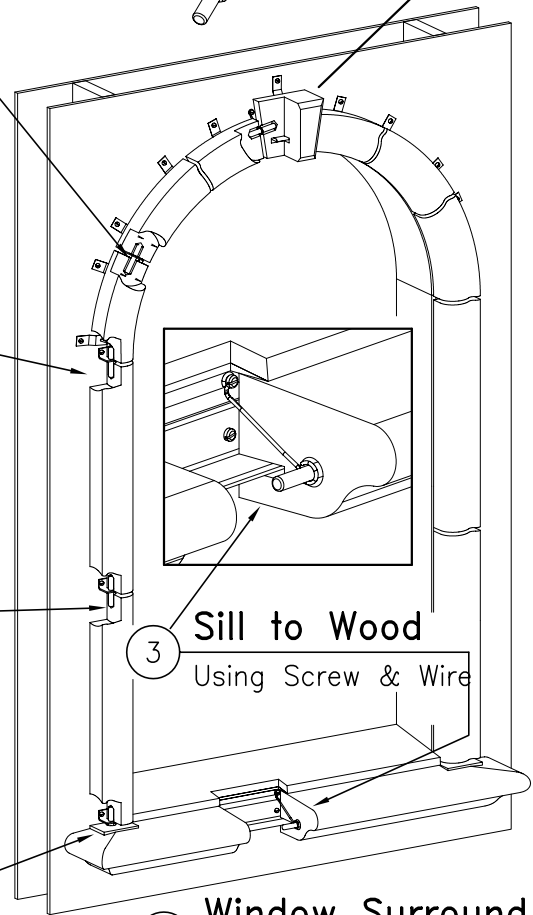
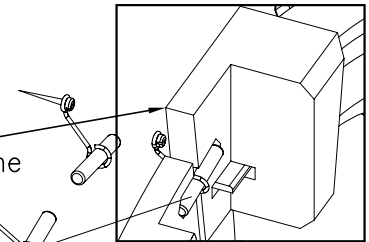

3 Sill to Wood

Using Screw & Wire

1 Window Surround

SCALE: NTS.

Design Options Keystone

How to Attach a Window Surround

Attachments & Interfaced to Wood & Stucco building. Window Circ Top/Ellipse/Eyebrow & Gothic. Top to Wood/Stucco using Straps & Screws.

Note: The requirements for attaching stone to structures, varies among the different States. A certified engineer that is familiar with the Geologic Seismic & Climatic conditions of your area must determine the best method for attaching the stone to the structure. The stone supplier is not responsible for providing information on attachment methods and can only provide suggested attachment methods. These suggested methods are well known and have been used throughout the industry. The Stucco/Stone must hide all attachments.

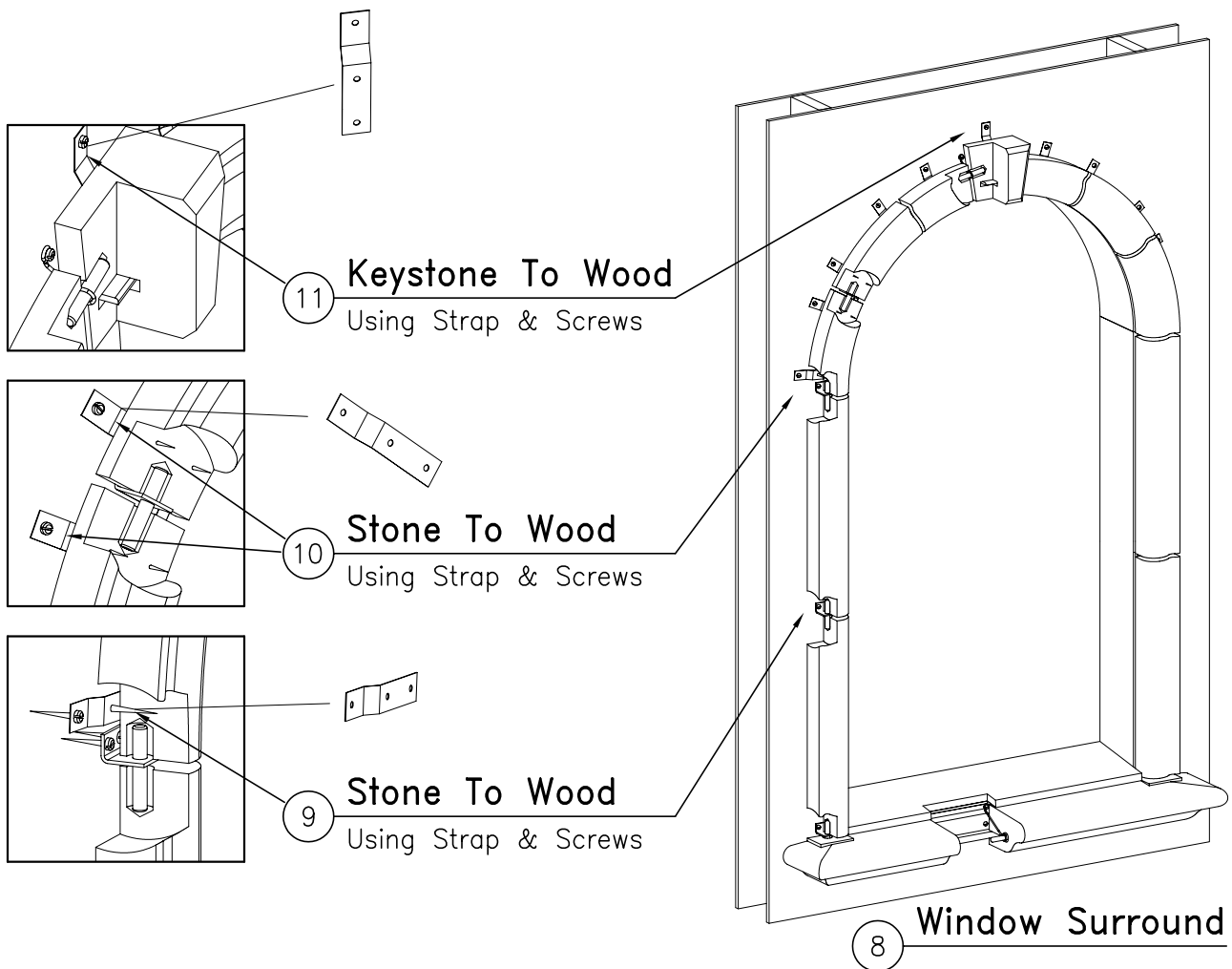

SCALE: 1" = 1'-0"

Design Options Keystone

How to Attach a Window Surround

Attachments & Interfaced to Wood & Stucco building. Window Circ Top/ Ellipse/ Eyebrow & Gothic. Top to Wood/Stucco using Lintels & Screws.

Note: The requirements for attaching stone to structures, varies among the different States. A certified engineer that is familiar with the Geologic Seismic & Climatic conditions of your area must determine the best method for attaching the stone to the structure. The stone supplier is not responsible for providing information on attachment methods and can only provide suggested attachment methods. These suggested methods are well known and have been used throughout the industry. The Stucco/Stone must hide all attachments.

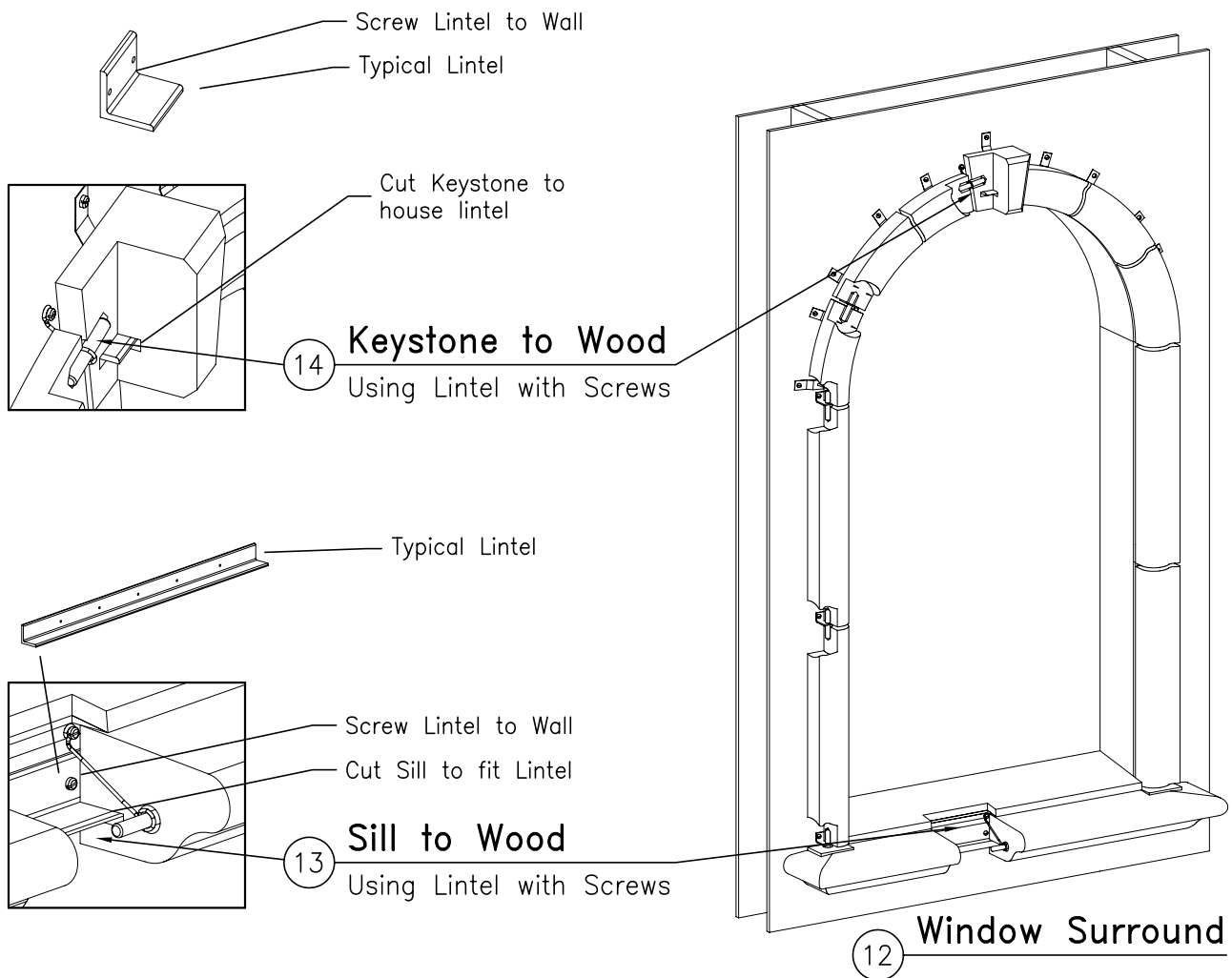

SCALE: 1" = 1'-0"

Design Options Keystone

Cutting & Fitting of a Keystone

Window Surround to Profile Based Sill, CUTTING DETAILS

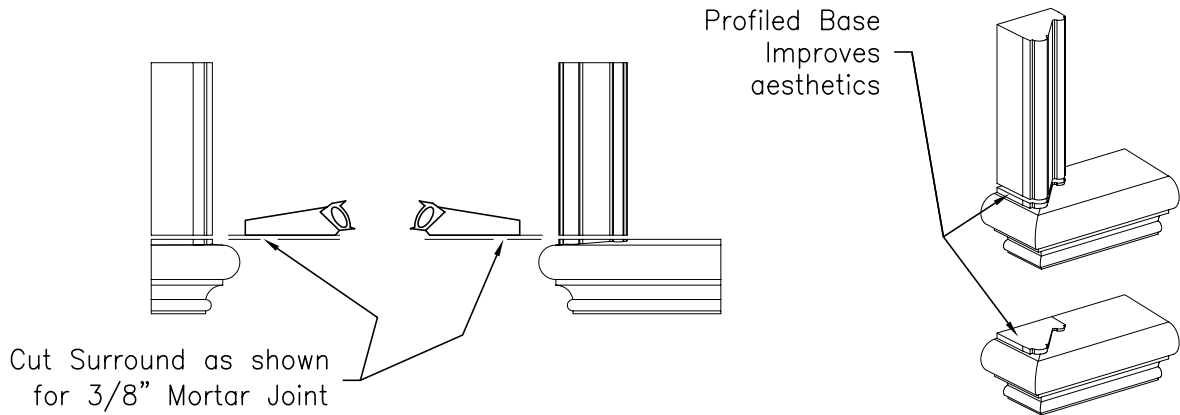

9 Side View
Cutting Details

10 Front View
Cutting Details

11 Isometric View
NOTE:
Sill has a Profiled base which, simplifies cutting in the field.

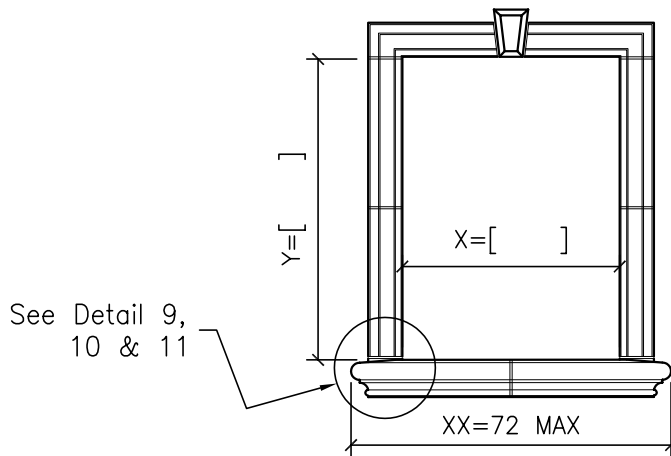

12 Square Top Window Surround Layout

| | |
|-------------------------------------|----------------------|
| <input type="checkbox"/> | AttachmentsInterface |
| <input checked="" type="checkbox"/> | DesignOptions |
| <input type="checkbox"/> | Flashing |
| <input checked="" type="checkbox"/> | CuttingFitting |
| <input type="checkbox"/> | BuildingCode |
| <input checked="" type="checkbox"/> | Measuring |
| <input type="checkbox"/> | DesignOptions |
| <input type="checkbox"/> | Masonry Structure |
| <input type="checkbox"/> | Steel Structure |
| <input type="checkbox"/> | StoneVeneer |
| <input type="checkbox"/> | StuccoVeneer |
| <input type="checkbox"/> | WoodStructure |
| <input type="checkbox"/> | BrickVeneer |

SCALE: NTS.

Design Options Keystone

Cutting & Fitting of a Keystone

Window Surround to Square Based Sill, CUTTING DETAILS

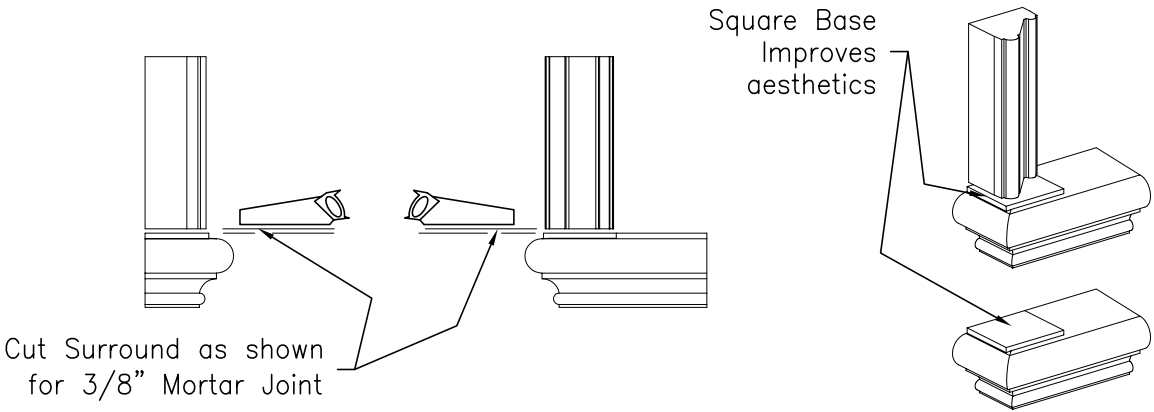

5 Side View
Cutting Details

6 Front View
Cutting Details

7 Isometric View
NOTE:
Sill has a SQ. base
which, simplifies
cutting in the field.

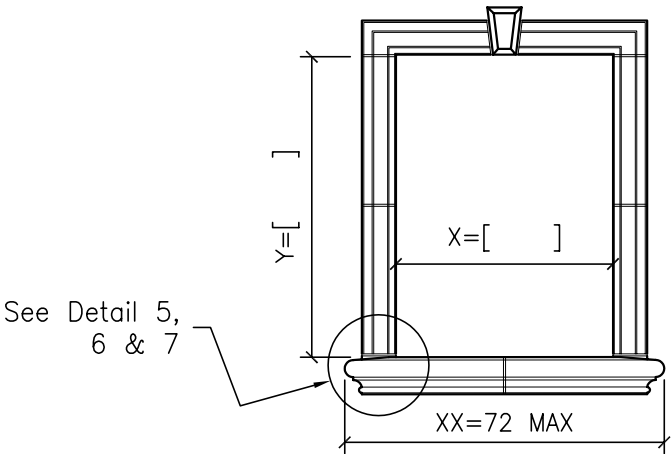

8 Square Top Window Surround Layout

| | |
|-------------------------------------|----------------------|
| <input type="checkbox"/> | AttachmentsInterface |
| <input checked="" type="checkbox"/> | DesignOptions |
| <input type="checkbox"/> | Flashing |
| <input checked="" type="checkbox"/> | CuttingFitting |
| <input type="checkbox"/> | BuildingCode |
| <input checked="" type="checkbox"/> | Measuring |
| <input type="checkbox"/> | DesignOptions |
| <input type="checkbox"/> | Masonry Structure |
| <input type="checkbox"/> | Steel Structure |
| <input type="checkbox"/> | StoneVeneer |
| <input type="checkbox"/> | StuccoVeneer |
| <input type="checkbox"/> | WoodStructure |
| <input type="checkbox"/> | BrickVeneer |

SCALE: NTS.

Design Options Keystone

Cutting & Fitting of a Keystone

Window Surround to Standard Sill CUTTING DETAILS

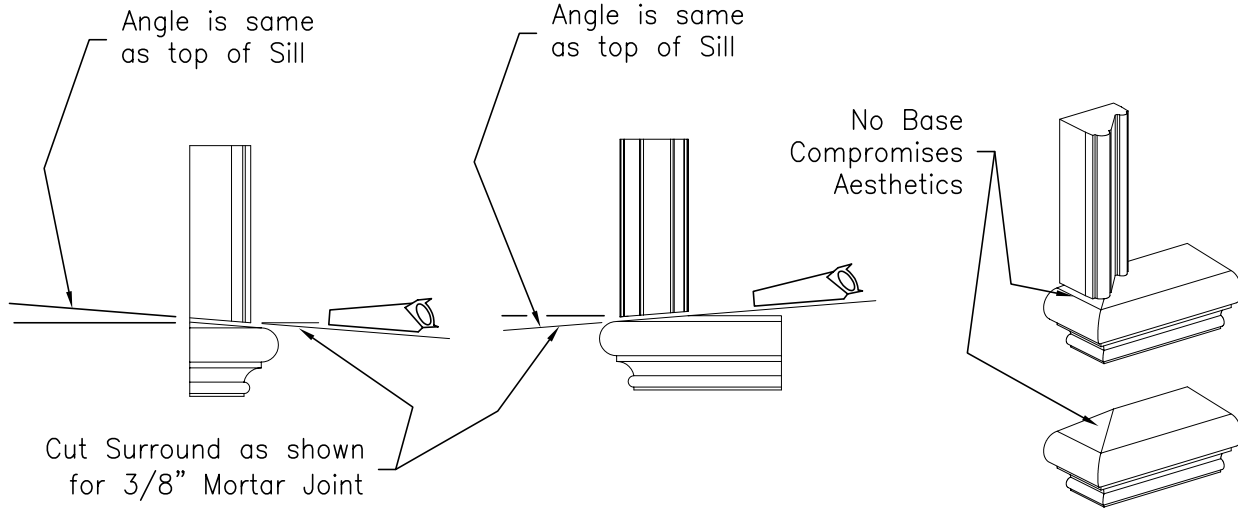

1 **Side View**
Cutting Details

2 **Front View**
Cutting Details

3 **Isometric View**
NOTE:
Sill has no base which,
complicates cutting in
the field.

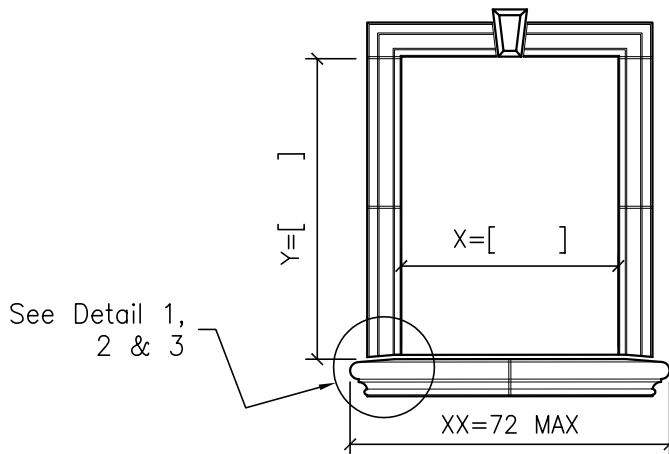

4 **Square Top Window Surround Layout**

| | |
|-------------------------------------|----------------------|
| <input type="checkbox"/> | AttachmentsInterface |
| <input checked="" type="checkbox"/> | DesignOptions |
| <input type="checkbox"/> | Flashing |
| <input checked="" type="checkbox"/> | CuttingFitting |
| <input type="checkbox"/> | BuildingCode |
| <input checked="" type="checkbox"/> | Measuring |
| <input type="checkbox"/> | DesignOptions |
| <input type="checkbox"/> | Masonry Structure |
| <input type="checkbox"/> | Steel Structure |
| <input type="checkbox"/> | StoneVeneer |
| <input type="checkbox"/> | StuccoVeneer |
| <input type="checkbox"/> | WoodStructure |
| <input type="checkbox"/> | BrickVeneer |

SCALE: NTS.