

# Banding Attachment

Attaching Banding/Entablature to a steel structure using Angle Iron, Round bar spacers, pins and wire

Optional wood frame uses alternative fasteners but the basics are the same

Example:  
Wire

Example:  
Pin

Example:  
Wire

Example:  
Pin

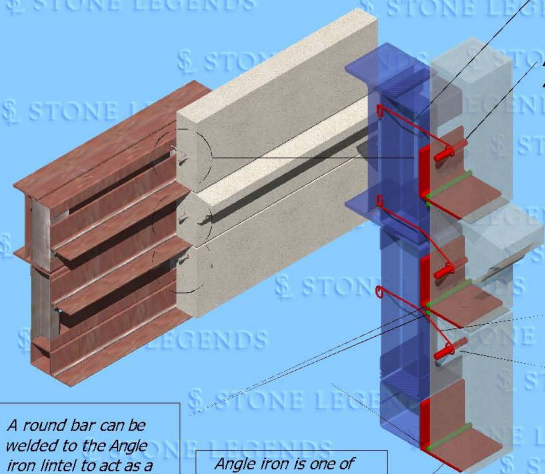

A round bar can be welded to the Angle iron lintel to act as a backstop so that the correct setting line offset can be achieved. (See explanation on **Setting Line**) Other materials such as wood blocks, plastic spacers or a dab of mortar can be used behind the stone to achieve the same result.

Angle iron is one of the most efficient lintels that can be used to carry stone. Stone can be carried on top of the lintel if the lintel can be hidden or a slot can be kerfed in the back of the stone to hide the lintel.

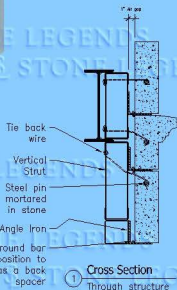

## Example Banding