

Face stone beyond

Stone trim at line of ceiling

beam

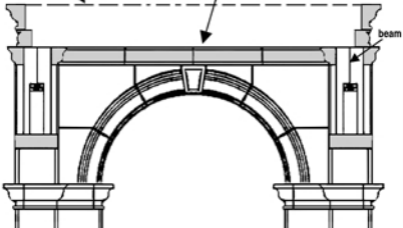

Flashing as required.

6-3/4"

1" x 1-1/2" assembly holes. Pin & anchor strap to frame. Typical.

All framing and flashing by others.
Note: Allow 1/8" min. between stone & wood.

Exposed steel lintel by others

8"

2"

8"

5"

12"

3/8" m. j.
typical

36-7/8"

119-5/8"

to bottom of column base

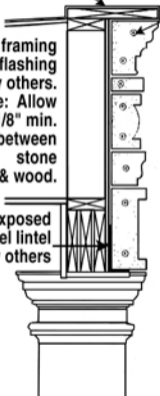

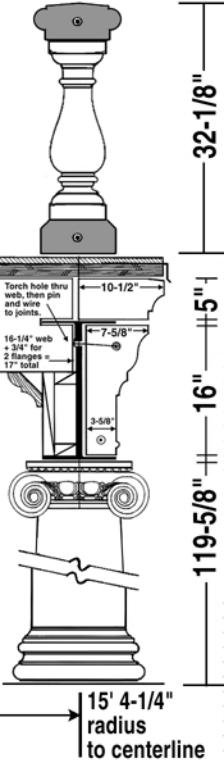

H-10-7/16"-I

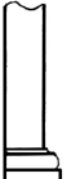

H-6-1/2"-I

10-Ft. Tapered Tuscan Pilaster — 24" 3-course Entablature

8-Ft. Tapered Corinthian Pilaster

20-Feet

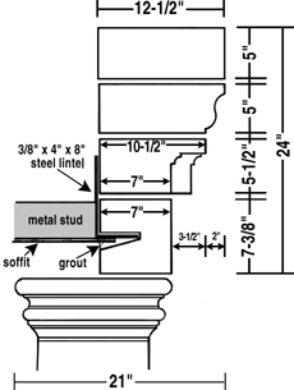

Technical Information: Profile Setting Beds

For: Entablature alignment to ensure stacked profiles matches up and installs correctly.

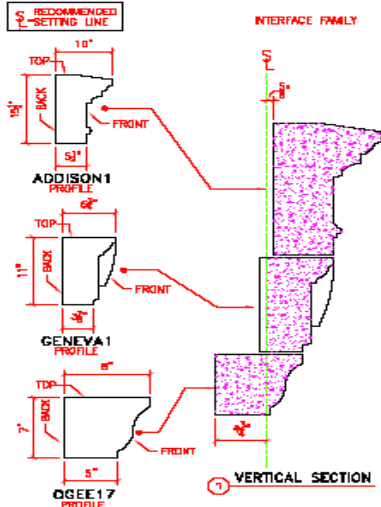

Ogee17 Bottom Profile
 Geneva1 Middle Setting Bed
 Addison1 Top **4 3/4 inches**

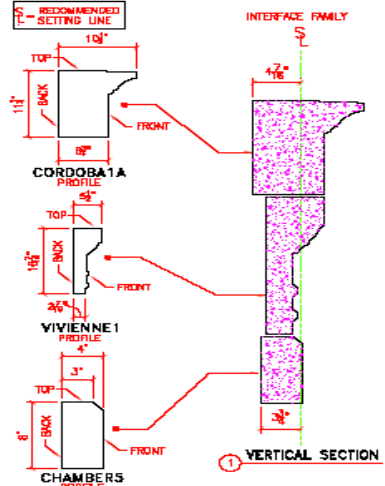

Chamber5 Bottom Profile
 Vivienne1 Middle Setting Bed
 Cordoba1A Top **4 7/16 inches**

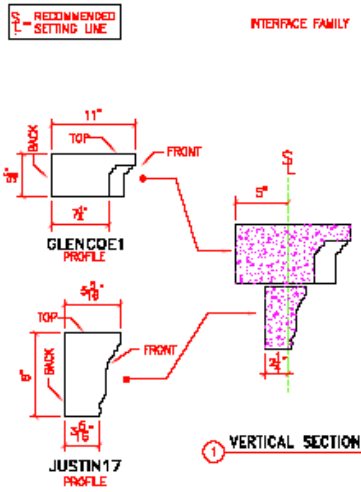

Justin17 Bottom Profile
 Glencoe1 Top Setting Bed **5 inches**

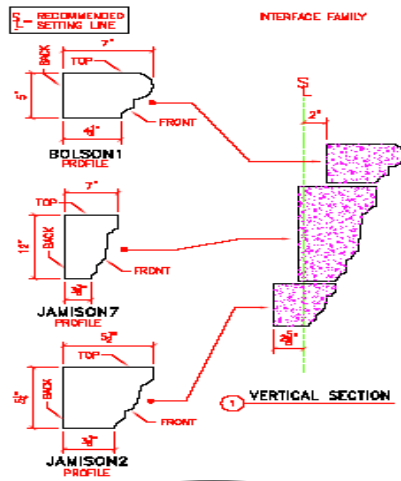

Boilson1 Bottom Profile
 Jamison7 Middle Setting Bed
 Jamison2 Top **2 5/8 inches**